

LOD

Installation

Instructions



POLARIS RANGER

2013+

**FRONT BUMPER
DESTROYER SERIES**

Installation

Bumper/Winch Mount Plate

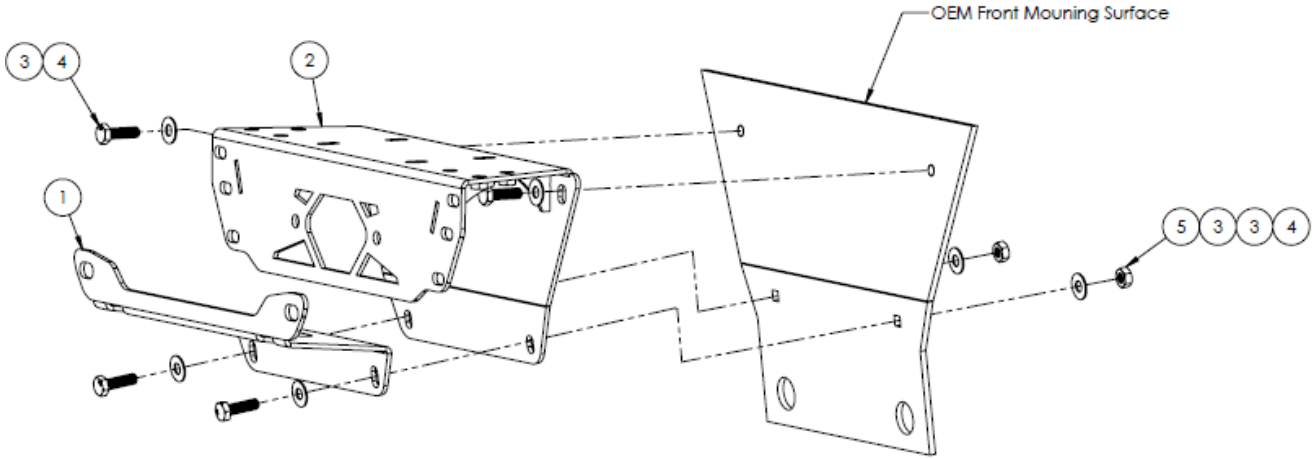

ITEM	QTY	PART	DESCRIPTION	ITEM	QTY	PART NUMBER	DESCRIPTION
1	1	2PFB1300-18	Lower Bumper Support	4	4	HB10150M35	HB M10-1.5 x 35mm, ZP
2	1	4PFB1300-02	Front Bumper/Winch Mount	5	2	HN10150M	HN M10-1.5, ZP
3	6	FW3816	FW 3/8" x 1.00, ZP				

Note: Remove the OEM front bumper from the UTV

1. If you're using a winch, install it on the LOD Front Bumper/Winch Mount using the slotted holes on the top of the mount.

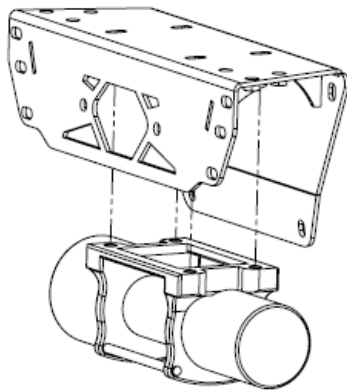

Figure 1. Install Winch

2. Locate the Front Bumper/Winch Plate, Lower Bumper Support and mount them using the M10 fasteners listed above. See Figure 2

Important: Bumper comes with M10 and 3/8" hardware. Be sure you are using the correct hardware. If bolt becomes difficult to thread on nut, STOP to make sure you have the correct fasteners.

Note: Weld nuts are on the back side of the OEM top mounting surface.

3. Leave the bolts loose enough so that the support and mount can be moved during the final adjustment stage.

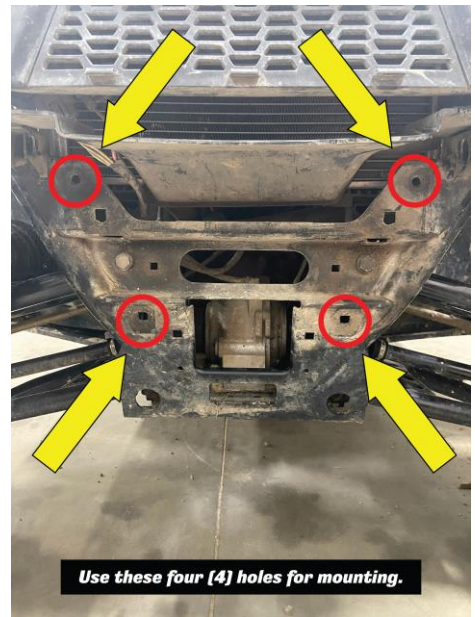
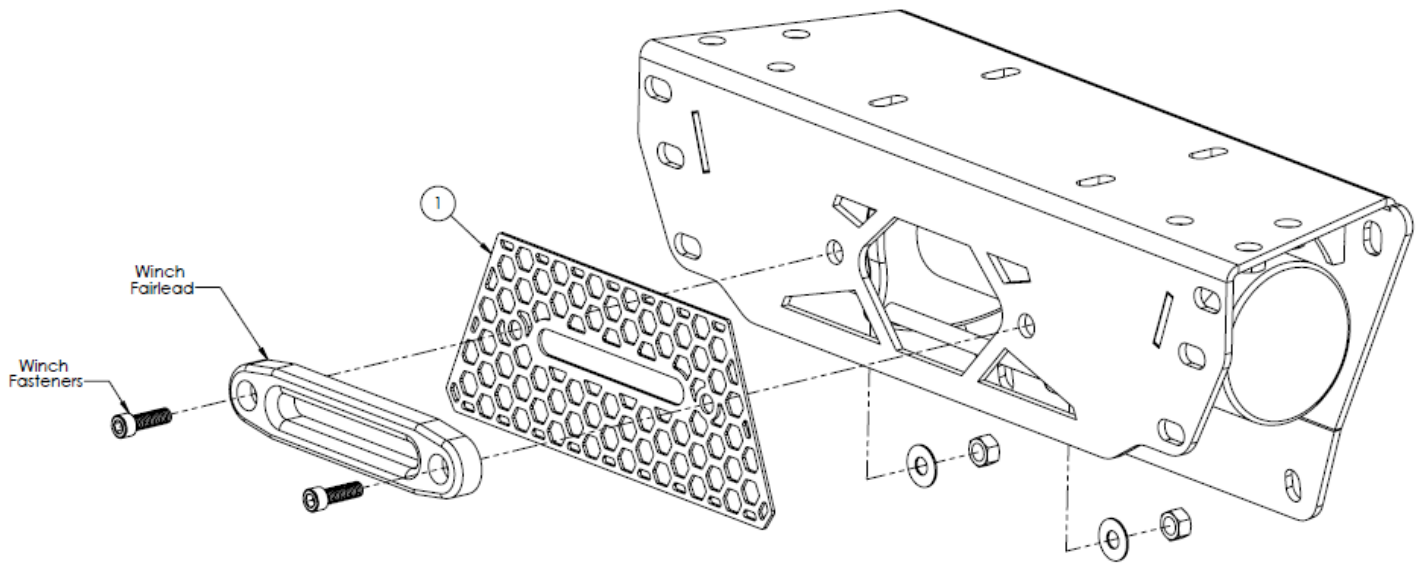

Figure 2. Use These Mounting Holes for Install

Screen Installation – With Winch



ITEM	QTY	PART NUMBER	DESCRIPTION
1	1	2PFB1300-17	Screen

1. Using the fasteners supplied by the winch company, install the LOD Screen between the fairlead and the LOD mount.

Note: This kit includes two (2) M10-1.5 Hex Nuts incase the nuts for the fairlead are not useable.

Screen Installation – No Winch

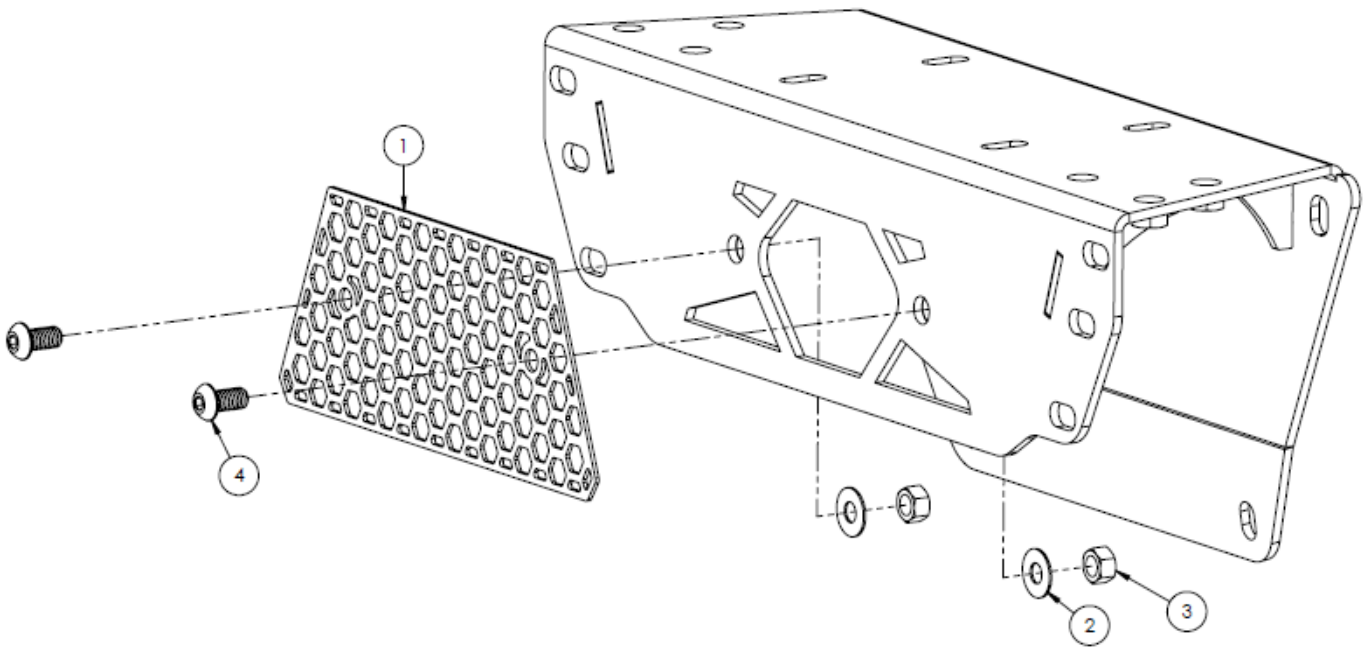

ITEM	QTY	PART	DESCRIPTION	ITEM	QTY	PART NUMBER	DESCRIPTION
1	1	2PFB1300-16	Screen	3	2	HN3816ZPGR5	Hex Nut 3/8-16
2	2	FW3114ZP	Flat Washer 3/8"	4	2	BHSCS381612	BHCS 3/8-16 x .75

1. Install the Screen as shown above using the 3/8" fasteners.

Upper Screen Installation

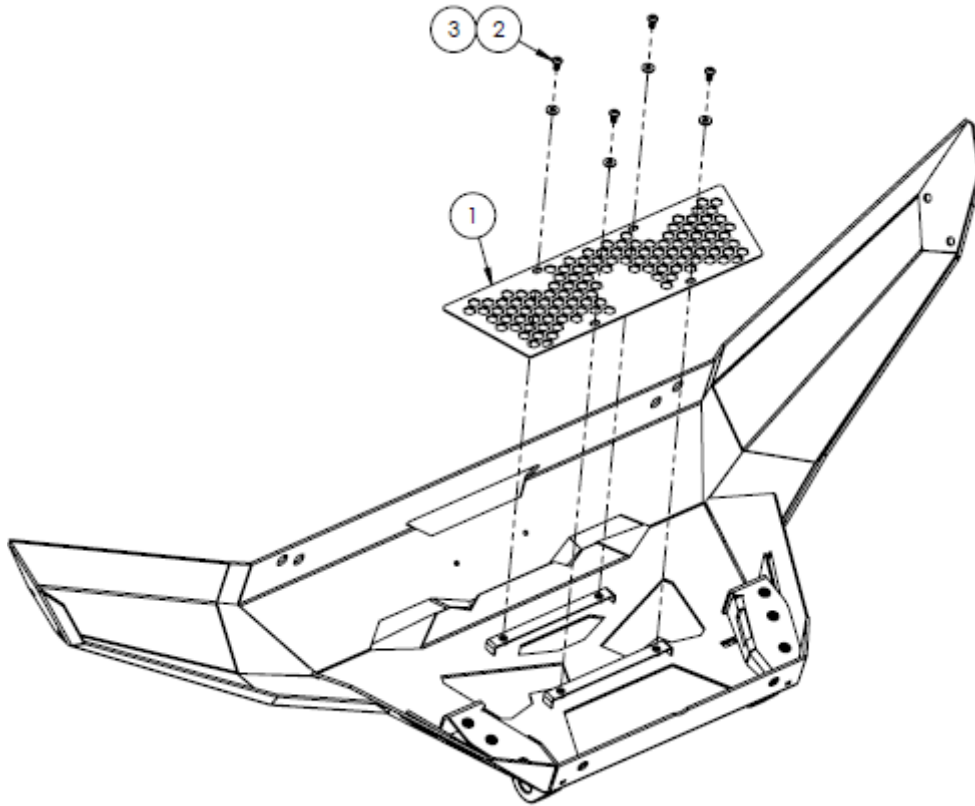

ITEM	QTY	PART NUMBER	DESCRIPTION	ITEM	QTY	PART NUMBER	DESCRIPTION
1	1	2PFB1300-12	Upper Screen	3	4	FW1209ZP	FW #12 x .56"
2	4	BHSCS252008ZP	BHCS 1/4-20 x .50				

1. Install the Upper Screen into the backside of the Front Bumper using the 1/4" and #12 hardware.

Stiffener Brackets Installation

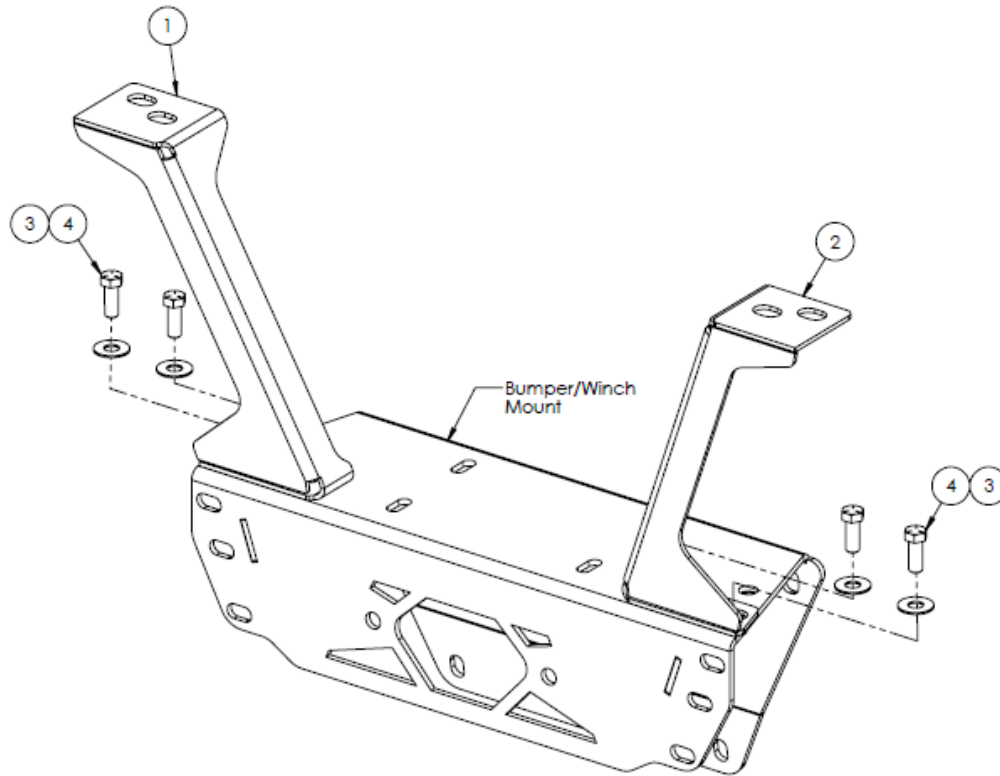

ITEM	QTY	PART	DESCRIPTION	ITEM	QTY	PART NUMBER	DESCRIPTION
1	1	2PFB1300-22	Stiffener Bracket, RH	3	4	FW3816ZP	FW 3/8"
2	1	2PFB1300-23	Stiffener Bracket, LH	4	4	HB381616ZPGR5	HB 3/8-16 x 1"

1. Locate both Stiffener Brackets and place it on to the Front Bumper/Winch Mount.
2. Using the 3/8" fasteners secure each Stiffener Bracket to the point. Fasteners should be installed loose at this point

Important: Bumper comes with M10 and 3/8" hardware. Be sure you are using the correct hardware. If bolt becomes difficult to thread on nut, STOP to make sure you have the correct fasteners.

Front Bumper Installation

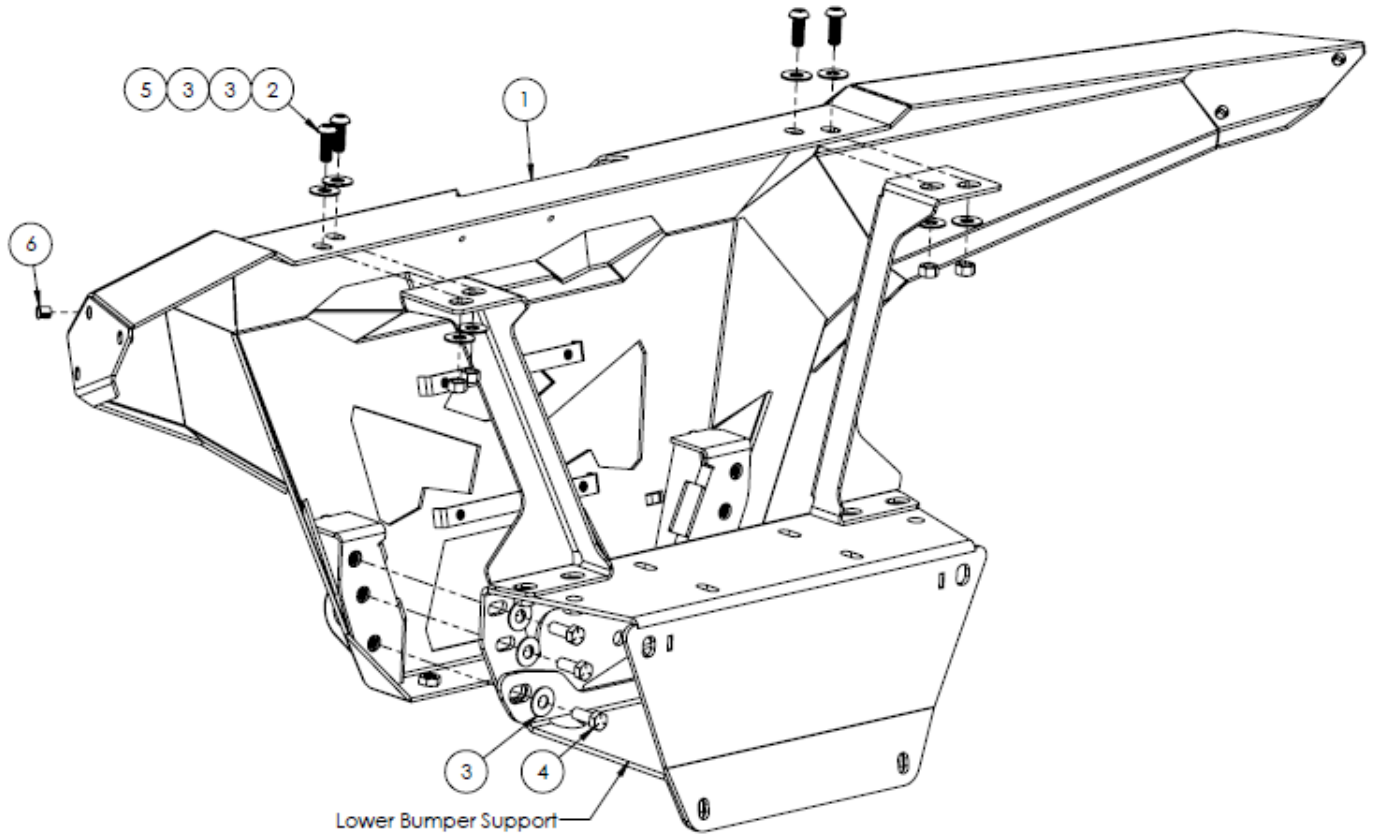

ITEM	QTY	PART NUMBER	DESCRIPTION	ITEM	QTY	PART NUMBER	DESCRIPTION
1	1	4PFB1310-01	Front Bumper	4	6	HB381616ZPGR5	Hex Bolt 3/8-16 x 1"
2	4	BHSCS381616ZP	Button Head 3/8-16 x 1"	5	4	HN3816ZPGR5	Hex Nut 3/8-16
3	14	FW3816ZP	FW 3/8"	6	6	HP1008	Hole Plug, 3/8"

1. Locate the Front Bumper and place it up to the Front Bumper/Winch Mount.
2. Using the 3/8" fasteners, secure the Front Bumper to the mount. Fasteners should be installed loose at this point

Important: Bumper comes with M10 and 3/8" hardware. Be sure you are using the correct hardware. If bolt becomes difficult to thread on nut, STOP to make sure you have the correct fasteners.

Note: Be sure the bottom bolts pass through the Lower Bumper Support as shown above.

3. Using the 3/8" fasteners, loosely secure the bumper to the Stiffener Brackets.
4. With the bolts loose now is the time to adjust the bumper and mount to sit how you like.
5. With everything adjusted you can begin to tighten all the bolts.
6. Use the 3/8" Hole Plugs to cover the unused holes on the wings of the bumper.

****Maintenance****

- Periodically check and re-tighten all fasteners.
-
- Periodically check your product for scratches, dings, or rust spots which can happen over time or after heavy use. It is important to address these areas as soon as possible to prevent rust and corrosion from spreading. We recommend using Rustoleum® brand Black Semi-Gloss Protective Enamel (oil based). Apply using a foam brush by dabbing to match the powder coat texture.





Polaris Ranger
DESTROYER SERIES
 FRONT BUMPER - CENTER
 SHIPPING SHEET - BOX 1

Packaged by:

On:



INSTRUCTION SHEET

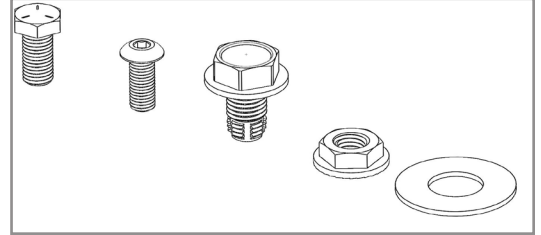

BOLT KIT
 PFB1310-BK
(x1)

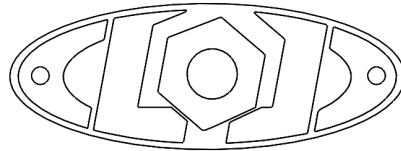

LOD LOGO
 (PACKAGED SEPERATE
 IF BUMPER IS BARE STEEL)

(x1)

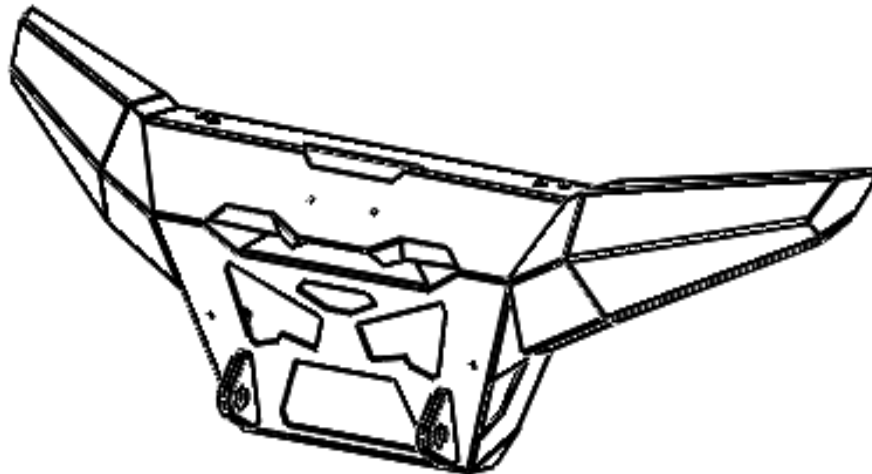

FRONT BUMPER
 4PFB1910-01



(x1)

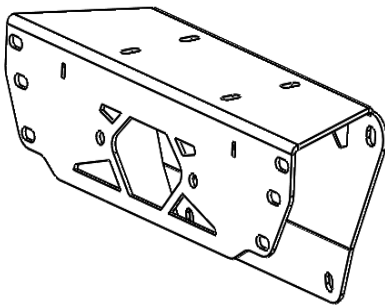

FRONT BUMPER/WINCH
 MOUNT
 4PFB1300-02



(x1)

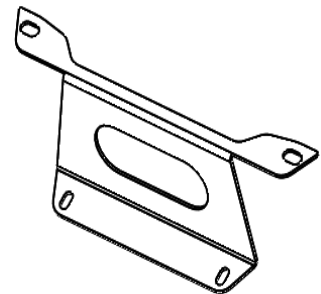

LOWER BUMPER SUPPORT
 2PFB1300-18



(x1)



Polaris Ranger
DESTROYER SERIES
FRONT BUMPER - CENTER
SHIPPING SHEET - BOX 1

Packaged by:

On:

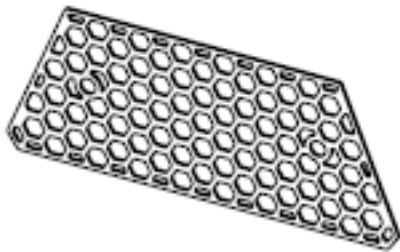

LOWER SCREEN
2PFB1300-16
(x1)

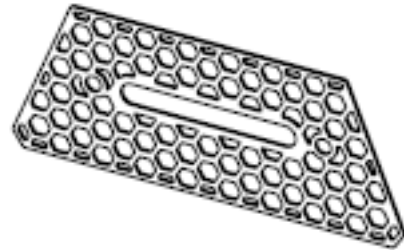

LOWER SCREEN
2PFB1300-17
(x1)

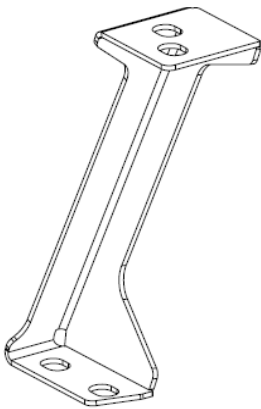

STIFFENER BRACKET, RH
2PFB1300-22
(x1)



STIFFENER BRACKET, LH
2PFB1300-23
(x1)

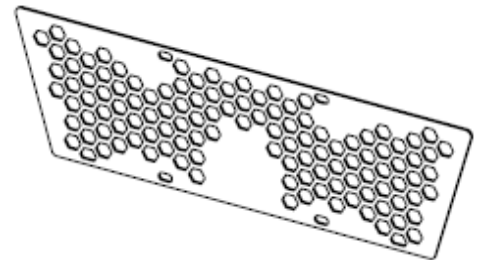

UPPER SCREEN
2PFB1300-12
(x1)





**POLARIS RANGER
DESTROYER SERIES**

FRONT BUMPER

Bolt Kit

Packaged by:

On:

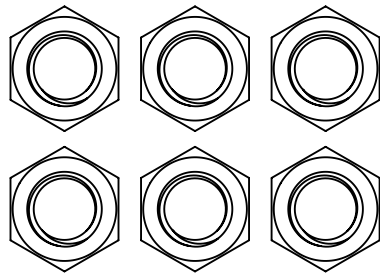

HEX NUT 3/8-16

(36306)

(x6)

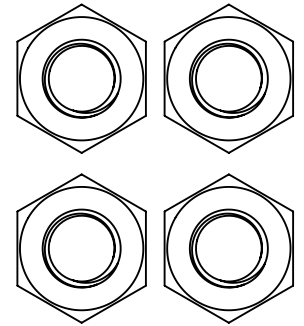

HEX NUT M10-1.5

(40308)

(x4)

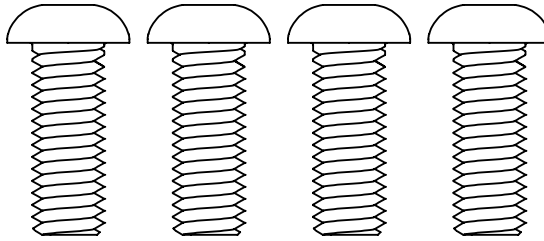

BUTTON HEAD SCREW

3/8-16 X 1.00"

(94092)

(x4)

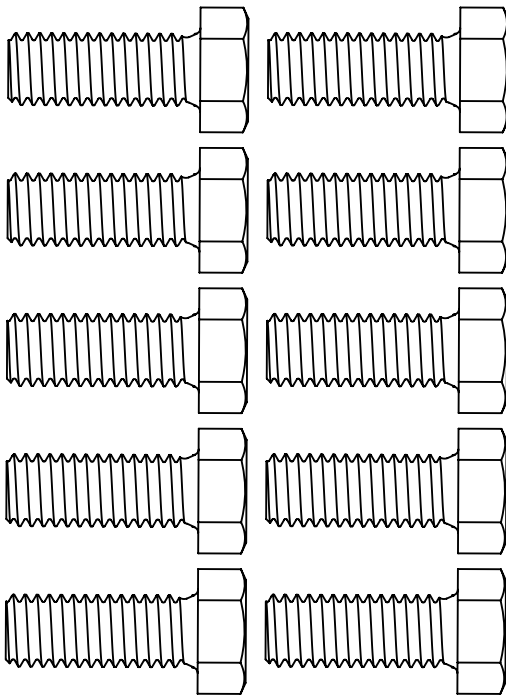

HEX BOLT 3/8-16 X 1.00"

(11105742)

(x10)

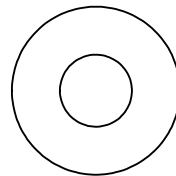

FLAT WASHER

Ø5/16 X .875"

(0159679)

(x2)

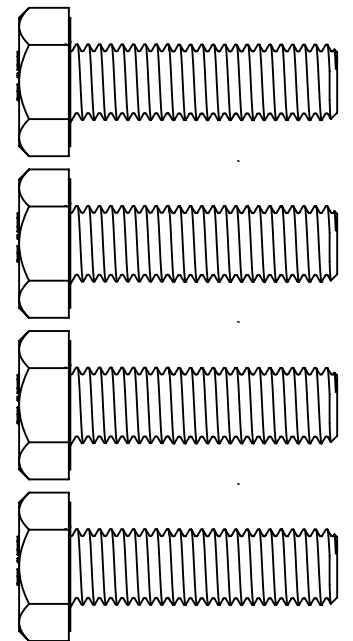

HEX BOLT M10-1.5 X 35MM

(0145161)

(x4)

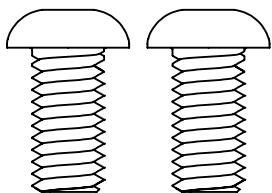

BUTTON HEAD SCREW

3/8-16 X .75"

(94090)

(x2)





**POLARIS RANGER
DESTROYER SERIES**

FRONT BUMPER

Bolt Kit

Packaged by:

On:

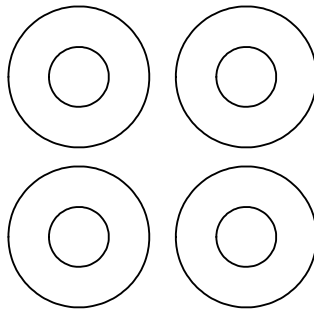

FLAT WASHER

Ø #12 X .56"

(33076)

(x4)

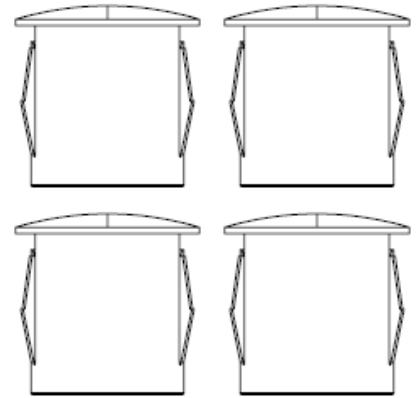

HOLE PLUG 3/8"

(HP1008)

(x4)

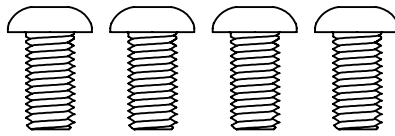

FLAT WASHER

1/4-20 X .50"

(94049)

(x4)

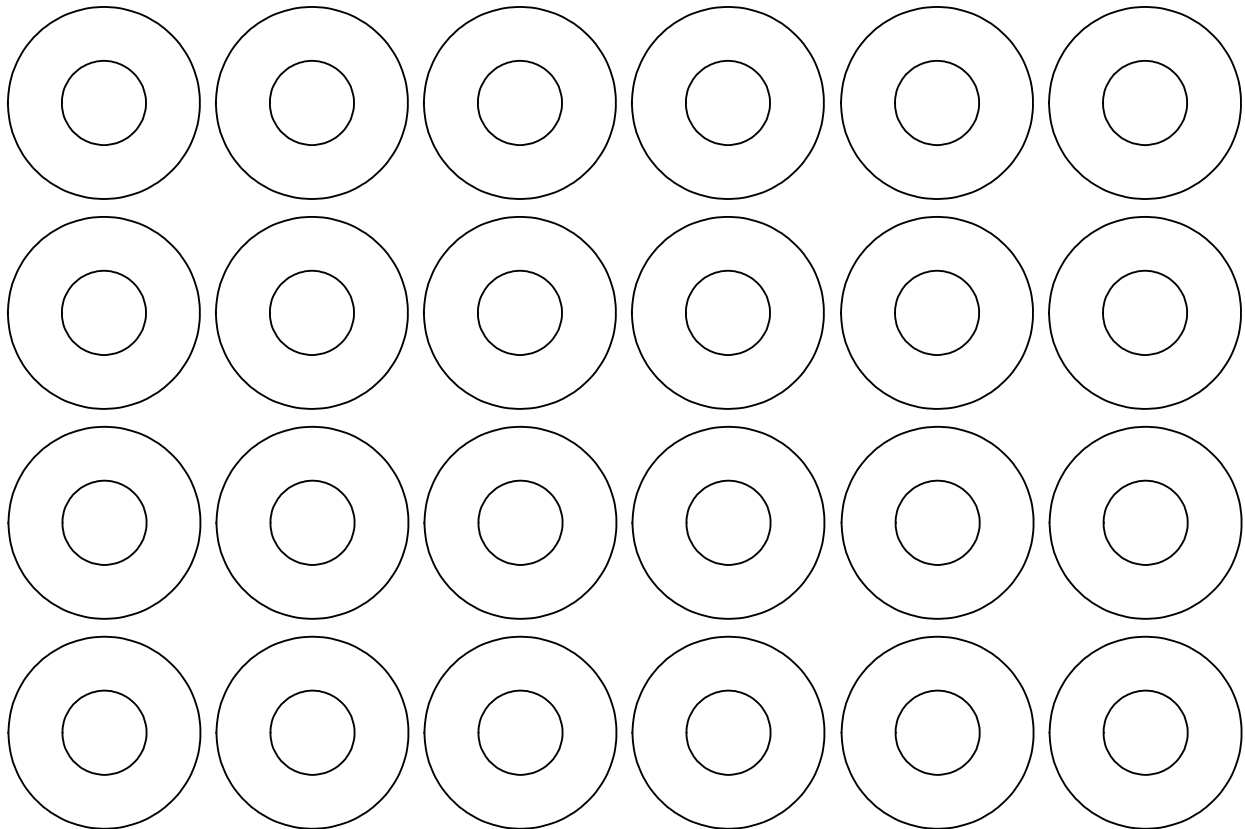

FLAT WASHER

Ø3/8" X 1.00"

(980295A451)

(x24)

