

## IMPORTANT:

The 2012-18 Jeep Wrangler has a vacuum switch located within the frame rails. This vacuum switch will need to be relocated to allow room for the LoD winch plate.



*Signature Series*



VACUUM PUMP  
RELOCATION  
BRACKET

**\*PLEASE READ THROUGH THE  
INSTRUCTIONS BEFORE BEGINNING  
ANY PART OF THE INSTALLATION  
PROCESS\***



BEGIN BY REMOVING THE GREEN CLIP THAT SECURES THE VACUUM LINE TO THE SWITCH. SIMPLY SLIDE THE CLIP DOWN AND PULL THE LINE OFF THE SWITCH.



# 3.

REMOVE THE TWO NUTS THAT SECURE THE SWITCH. YOU CAN LEAVE THE SWITCH WIRING CONNECTED. MOVE THE SWITCH AWAY FROM THE MOUNTING TAB WITH STUDS.



# 4.

WITH THE SWITCH OUT OF THE WAY CUT OFF THE TAB THAT IS CLOSEST TO THE FRONT OF THE JEEP AS SHOWN IN THIS PHOTO, ON THE DRIVER SIDE FRAME MOUNT.

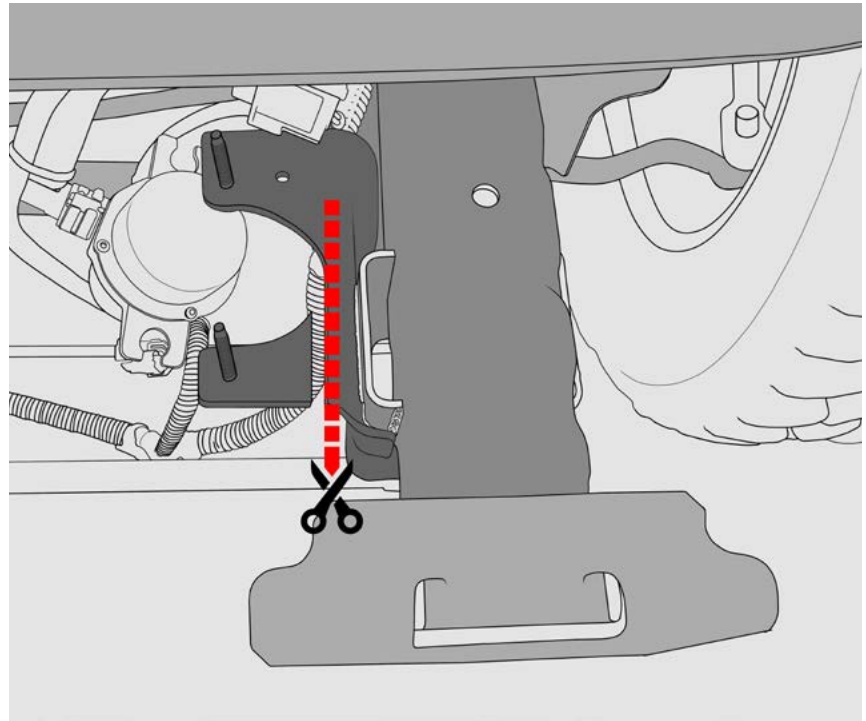
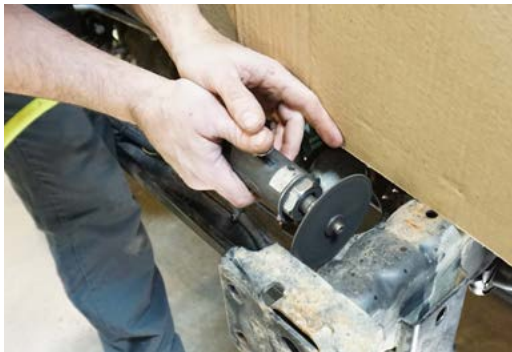

# 5.

PLACE THE LOD RELOCATION BRACKET UP UNDER THE CROSS MEMBER AS SHOWN IN THE PICTURE. BOLT THE BRACKET ON USING THE BOLTS PROVIDED WITH THE KIT. THE BRACKET WILL MOUNT DIRECTLY INTO THE EXISTING HOLES SO THERE IS NO DRILLING REQUIRED.



6.

---

WITH THE BRACKET INSTALLED BOLT THE VACUUM SWITCH TO THE BRACKET AS SHOWN. THE SWITCH WILL BE REPOSITIONED ON ITS SIDE IN THE NEW BRACKET.



7.

---

RE-CONNECT THE VACUUM LINES THAT WERE REMOVED EARLIER.

WHEN FINISHED THE VACUUM SWITCH SHOULD LOOK LIKE THE PICTURE TO THE RIGHT.



ITEM NO.	PART NUMBER	DESCRIPTION	QTY.
1	4JVC1216-01	VACUUM BRACKET WELDMENT	1

**BOLT KIT**

ITEM NO.	PART NUMBER	DESCRIPTION	QTY.
2	HB311816ZPGR5	HEX BOLT 5/16-18 X 1.00 ZINC PLATE GR5	2
3	FW3112ZP	FLAT WASHER Ø5/16" X .75" ZINC PLATE	4
4	HN3118ZPGR5	HEX NUT 5/16-18 ZINC PLATE GR5	2
5	PH102424CZP	PAN HEAD #10 X 1.50" COMBINATION SCREW ZINC PLATE	2
6	HNI024ZP	HEX NUT #10-24 ZINC PLATE	2
7	FW1010ZP	FLAT WASHER #10 X .625 ZINC PLATE	4
8	FW4318ZP	FLAT WASHER Ø7/16 X 1.25" ZINC PLATED	1

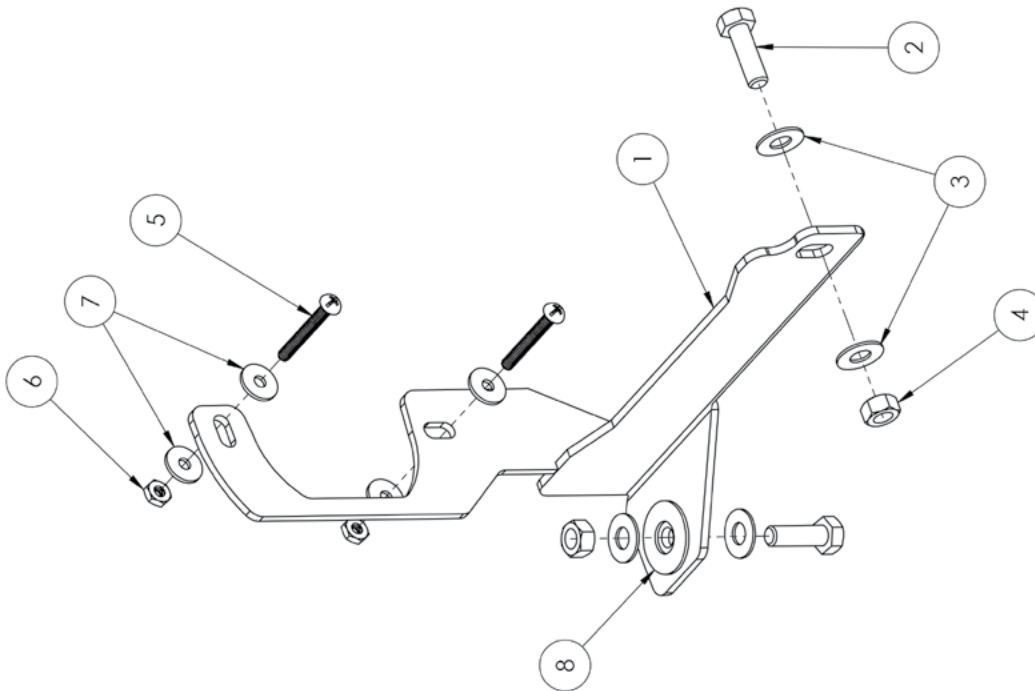

VACUUM PUMP RELOCATION BRACKET  
FOR SIG SERIES FRONT BUMPER

JVC1216



**JK Jeep**

*Signature Series*

Vacuum Pump Relocation

SHIPPING SHEET

Packaged by:

\_\_\_\_\_

On:

\_\_\_\_\_

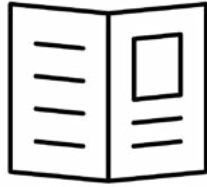

Instruction  
Booklet

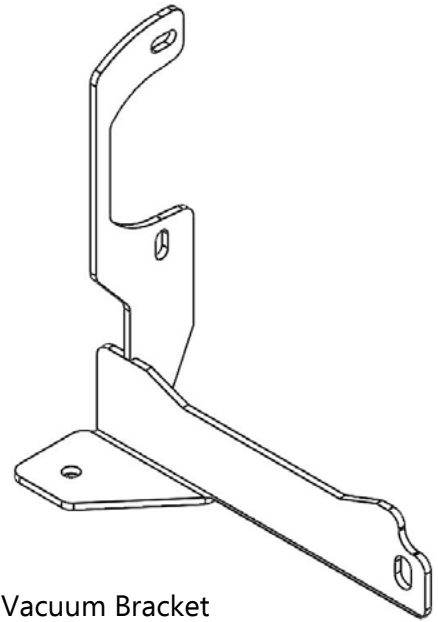

Vacuum Bracket  
Weldment

**(x1)**

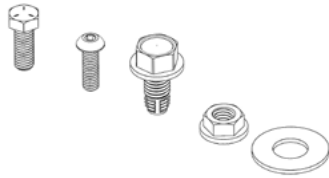

BOLT KIT  
(may vary)





**JK Jeep**

*Signature Series*

Vacuum Pump Relocation

Bolt Kit

Packaged by:

\_\_\_\_\_

On:

\_\_\_\_\_

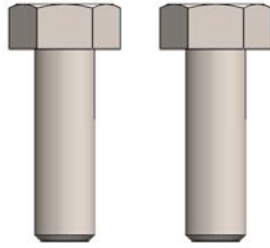

5/16"(18) x 1 Hex Bolts

**(2)**

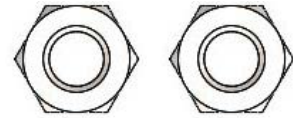

5/16"(18)  
Hex Nuts

**(2)**

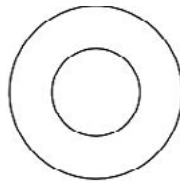

7/16" Flat Washer

**(1)**

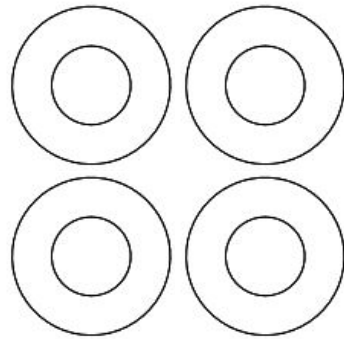

5/16" Flat Washers

**(4)**

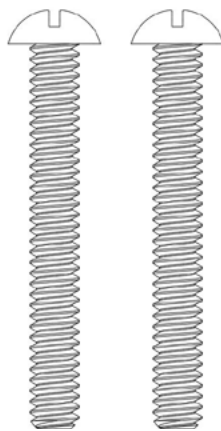

#10-24 x 2"  
Panhead Bolts

**(2)**



#10-24  
Hex Nut

**(2)**

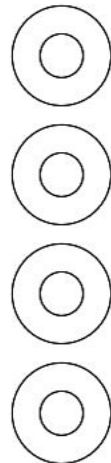

#10 Washers

**(4)**

