



DESTROYER SERIES

JK

JL

VERTICAL
HI LIFT
MOUNT

***PLEASE READ THROUGH THE
INSTRUCTIONS BEFORE BEGINNING
ANY PART OF THE INSTALLATION
PROCESS***

WEB INSTALL LINK:
<http://lodooffroad.com/assets/pdfs/JHL0710.pdf>

ITEM NO.	PART NUMBER	DESCRIPTION	QTY.
1	4JHL0710-01	VERT HI LIFT MOUNT	1

HARDWARE KIT

ITEM NO.	PART NUMBER	DESCRIPTION	QTY.
2	FW3814ZP	FLAT WASHER Ø3/8" X .875 ZINC PLATE	4
3	HN3118ZPGR5	HEX NUT 5/16-18 ZINC PLATE GR5	2
4	HN3816ZPGR5	HEX NUT 3/8-16 ZINC PLATE GR5	2
5	FW3112ZP	FLAT WASHER Ø5/16" X .75" ZINC PLATE	4
6	HB311816ZPGR5	HEX BOLT 5/16-18 X 1.00 ZINC PLATE GR5	2
7	HB381616ZPGR5	HEX BOLT 3/8-16 X 1.00 ZINC PLATE GR5	2

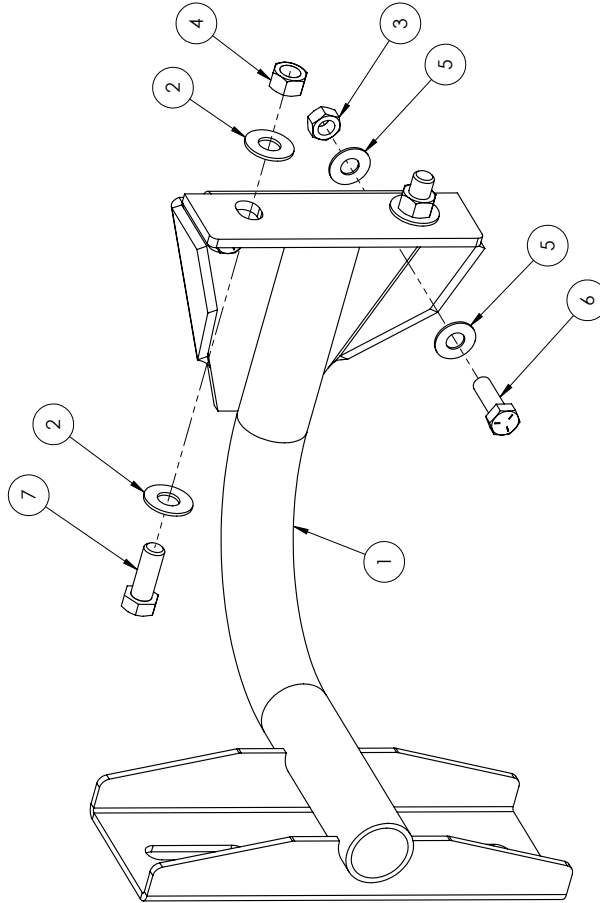

NOTES:

- JHL0710 = BARE STEEL OPTION
- JHL0711 = BLACK POWDER COAT OPTION

UNLESS OTHERWISE SPECIFIED:	DRAWN	NAME	DATE
DIMENSIONS ARE IN INCHES	MCH		6/5/18
TOLERANCES: ±0.010	CHECKED		
ANGULAR: MACH ±1°	ENG APPR:		
TWO PLACE DECIMAL	MFG APPR:		
THREE PLACE DECIMAL ±0.005	MATERIAL:		
	N/A		
PROPRIETARY AND CONFIDENTIAL	THIS DRAWING IS THE SOLE PROPERTY OF LOD LLC. ANY REPRODUCTION OR DISSEMINATION OF THIS DRAWING WITHOUT THE WRITTEN PERMISSION OF LOD LLC IS PROHIBITED.		
	SEE NOTES		
		DWG. NO.	REV
		JHL0710	A
		SCALE: 1:2	SHEET SIZE: B
			SHEET 1 OF 1



DESCRIPTION:
DESTROYER HI LIFT VERTICAL SIDE
MOUNT (UNIVERSAL)



JK/JL Jeep
DESTROYER SERIES
Vertical Hi Lift Mount
SHIPPING SHEET

Packaged by:

On:

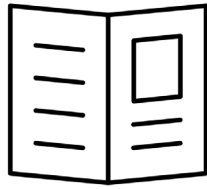

Instruction
Booklet

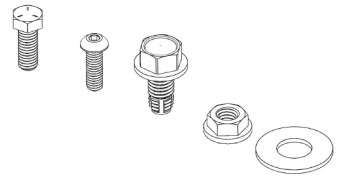

BOLT KIT
(may vary)

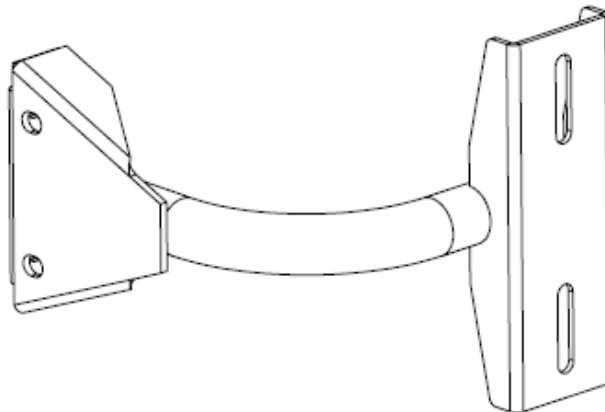

Vertical Hi Lift Mount Arm
4JHL0710-01
(X1)





JK/JL Jeep
DESTROYER SERIES
Vertical Hi Lift Mount

Bolt Kit
Packaged by:

On:

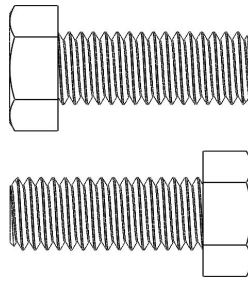

Hex Bolt
3/8"-16 x 1"
(x2)

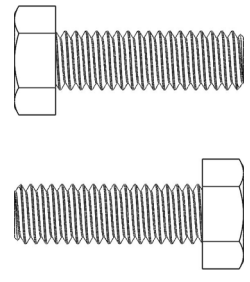

Hex Bolt
5/16"-18 x 1"
(x2)

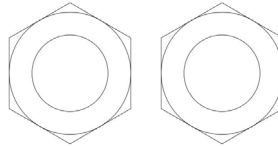

Hex Nut
3/8"-16
(x2)

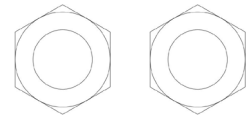

Hex Nut
5/16"-18
(x2)

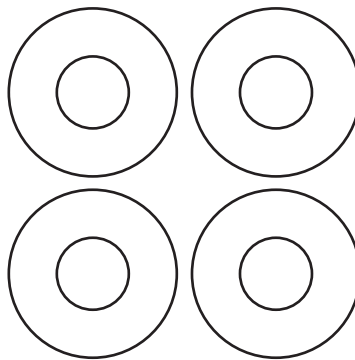

Flat Washer
3/8" x 0.875"
(x4)

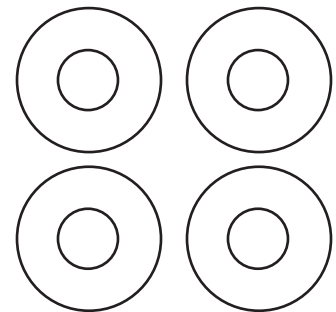

Flat Washer
5/16" x 0.75"
(x4)

